

70-S-59 - SPEEDLINE System Data Sheet - Version V1 (24-10-23)

SPEEDLINE 70mm 'C' Stud Partition @600mm Ctrs,
with 2x Siniat GTEC 12.5mm dB Board each side

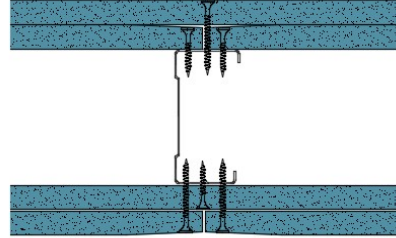

System Performance Breakdown

Fire Resistance:

BS476 Part 22:1987:

Test Ref & Date or Applied Ref & Report:

Max Height:

Thickness:

Duty Grade: BS 5234: Part 2:1992:

Sound Insulation:

60/60 Minutes (Integrity/Insulation).

- BRE Report P102396-1011C

Refer to Speedline Specification Clause

122 mm. (At Base Track, Excluding Finishes)

Severe - Annexes A-F

50 R_wdB, Date Tested or Assessed Against - 29/07/2011

Test Code:
H17510AA
Test Date:
29/07/2011

Freq. Hz	R dB
50	25.6
63	13.9
80	12.1
100	24.5
125	26.7
160	34.6
200	40.9
250	40.7
315	44.0
400	47.7
500	51.8
630	54.0
800	57.7
1 000	59.4
1 250	61.8
1 600	63.9
2 000	59.7
2 500	50.0
3 150	51.5
4 000	54.8
5 000	57.7
6 300	
8 000	
10 000	

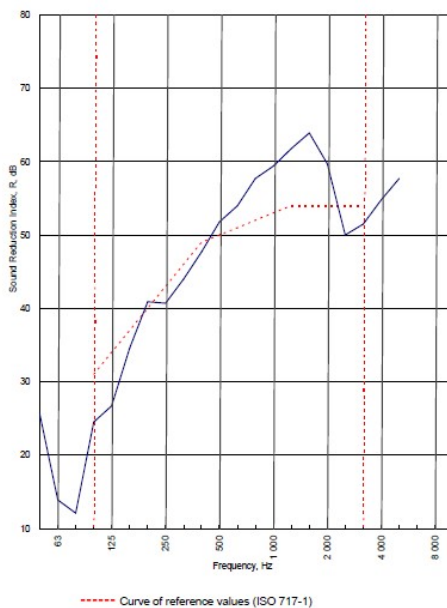



Rating according to BS EN ISO 717-1:1997	R_w (C;Ctr) = 50 (-3;-9) dB
Evaluation based on laboratory measurement results obtained by an engineering method:	Max dev. 7.3 dB at 125 Hz
	C ₅₀₋₃₁₅₀ = -8 dB C ₅₀₋₅₀₀₀ = -7 dB C ₁₀₀₋₅₀₀₀ = -2 dB
	C ₁₀₋₅₀₋₃₁₅₀ = -19 dB C ₁₀₋₅₀₋₅₀₀₀ = -19 dB C ₁₀₋₁₀₀₋₅₀₀₀ = -9 dB

TESTED AT ONE OF THE UKAS ACCREDITED LABORATORIES BELOW

B.T.C (H-Ref on Graph) 

B.R.E 

AIRO 

S.R.L 

Customer: Metsec plc Hepsec Division

BTC 17510A: Page 8 of 10



SPEEDLINE Drywall Systems, Adsetts House, 16 Europa View, Sheffield Business Park, Sheffield, S9 1XH.

Tel: 0114 231 8030.

Email: enquiries@speedlinedrywall.co.uk

(As per the requirements set out in ISO/IEC 17025:2017 regarding test data the results stated have been carried out by voestalpine Metsec plc as part of the contract to supply Speedline Metal Sections to SIG Plc)